

BUNUBA #2 PART A

DETERMINATION OF NATIVE TITLE

WAD 94 of 2012

SCHEDULE 2 - ATTACHMENT 1

LEGEND

- DETERMINATION AREA
- AREAS OF LAND SUBJECT TO EXCLUSIVE NATIVE TITLE
- AREAS OF LAND SUBJECT TO NON-EXCLUSIVE NATIVE TITLE
- AREAS WHERE NATIVE TITLE DOES NOT EXIST
- OTHER INTERESTS



NATIVE INTERESTS
 Cadastral and Tenure information sourced from Landgate Spatial Database (SDB) 3rd August 2015 & 25 Jun 2012. Cadastral information is sourced from the Landgate Administrative Boundaries Dataset. Coordinates and shapes are interpreted from aerial photography or recorded from ground surveys. Native title information is sourced from the Western Australian Native Title Register (WANTR). Islands shown are Unincorporated Crown Land (UCL) unless otherwise specified. Western Australian Land Information Authority (Lantia) as of 12/02/2016.

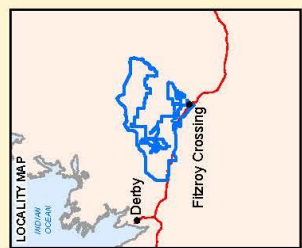

DISCLAIMER
 For informational purposes only. This map is an overview of the determination area and is intended to provide general information. It is not intended to be used as a legal document. The map is based on the best available information and is subject to change. The map is not a guarantee of accuracy and is not intended to be used as a legal document. The map is not a guarantee of accuracy and is not intended to be used as a legal document.

NATIVE TITLE SPATIAL SERVICES
 PRODUCED 12/02/2016



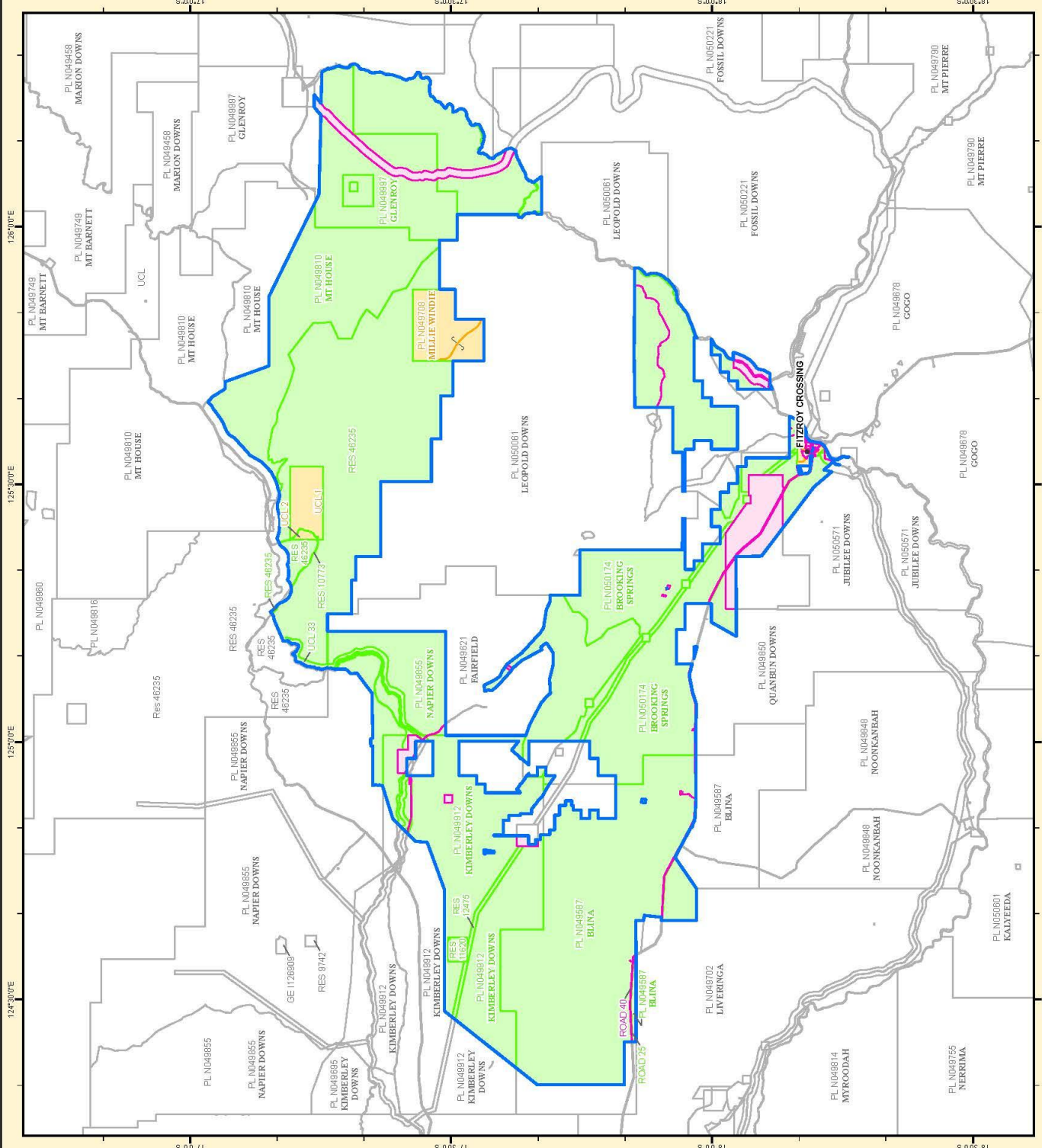

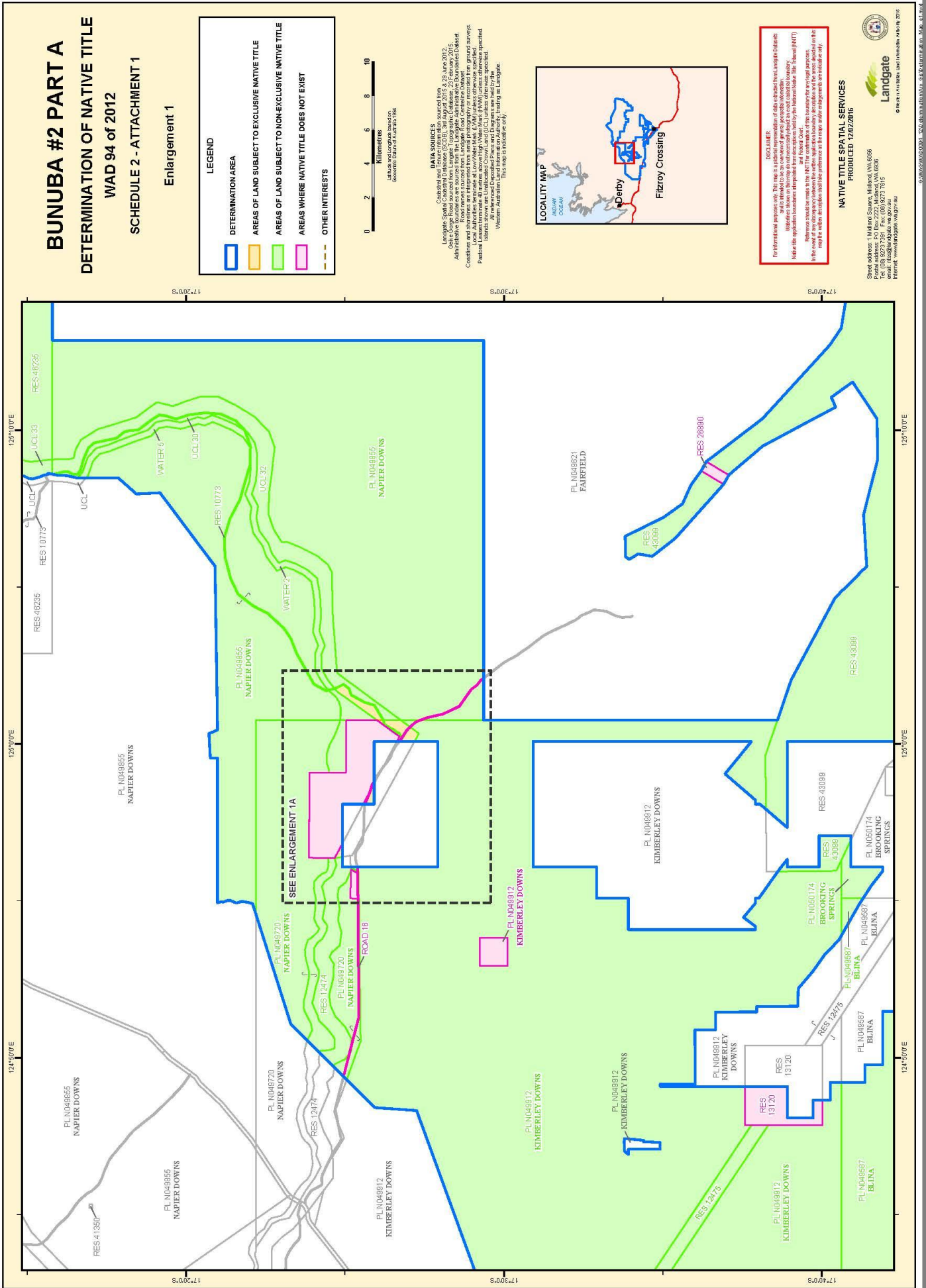
Landgate
 1 Midland Square, Midland, WA 6550
 Postal address: PO Box 2222, Midland, WA 6536
 Tel: (08) 9272 7291 Fax: (08) 9272 7515
 Internet: www.landgate.wa.gov.au





BUNUBA #2 PART A
DETERMINATION OF NATIVE TITLE
WAD 94 of 2012
SCHEDULE 2 - ATTACHMENT 1
Enlargement 2

LEGEND

	DETERMINATION AREA
	AREAS OF LAND SUBJECT TO EXCLUSIVE NATIVE TITLE
	AREAS OF LAND SUBJECT TO NON-EXCLUSIVE NATIVE TITLE
	AREAS WHERE NATIVE TITLE DOES NOT EXIST
	OTHER INTERESTS



DATA SOURCES:
Cadastral and NATS sources:
Landgate Spatial Cadastral Database (SCDB), 3rd August 2015 9:29 AM 2015
Landgate Native Title Determination Area (NTDA) Database, 12th August 2015 10:55 AM 2015
Administrative Boundaries are sourced from the Landgate Administrative Boundaries Dataset
Coordinates and street names are interpreted from aerial photography via Microsoft Map Point ground surveys
Pastoral Lease boundaries are sourced from the Department of Agriculture and Food Western Australia (DAFWA) Pastoral Leases Dataset
Pastoral Lease boundaries are shown in grey with a dashed line and a pink outline where they overlap with other boundaries
Boundaries shown are Unincorporated Crown Land (UCL) unless otherwise specified.
Western Australian Land Information Authority, trading as Landgate.
This map is indicative only.

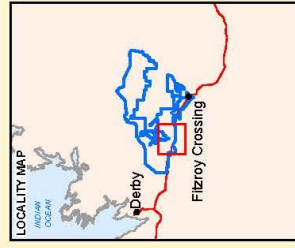

DISCLAIMER
For information purposes only. This map is a representation of data obtained from a range of databases and is intended to be an overview of general geographic information. It is not intended to be used for any other purpose.
Native Title applications boundaries are provided for information only by the National Native Title Tribunal (NNTT) and should not be relied upon for any legal purposes.
References should be made to the NTDA Database for any legal purposes.
In the event of any discrepancy between the written application boundary description and the areas depicted on this map, the written description shall take preference in the event of any dispute or disagreement on resolution only.

NATIVE TITLE SPATIAL SERVICES
PRODUCED 12/02/2016
Landgate
Street address: 1, Midland Square, Midland, WA 6950
Postal address: PO Box 2222, Midland, WA 6950
Telephone: (08) 9423 9973 / 9151
Internet: www.landgate.wa.gov.au
© 2016 The State of Western Australia. All rights reserved.

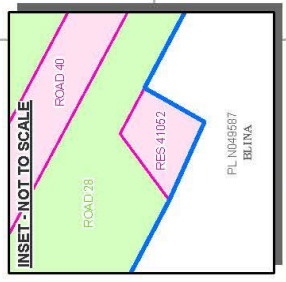
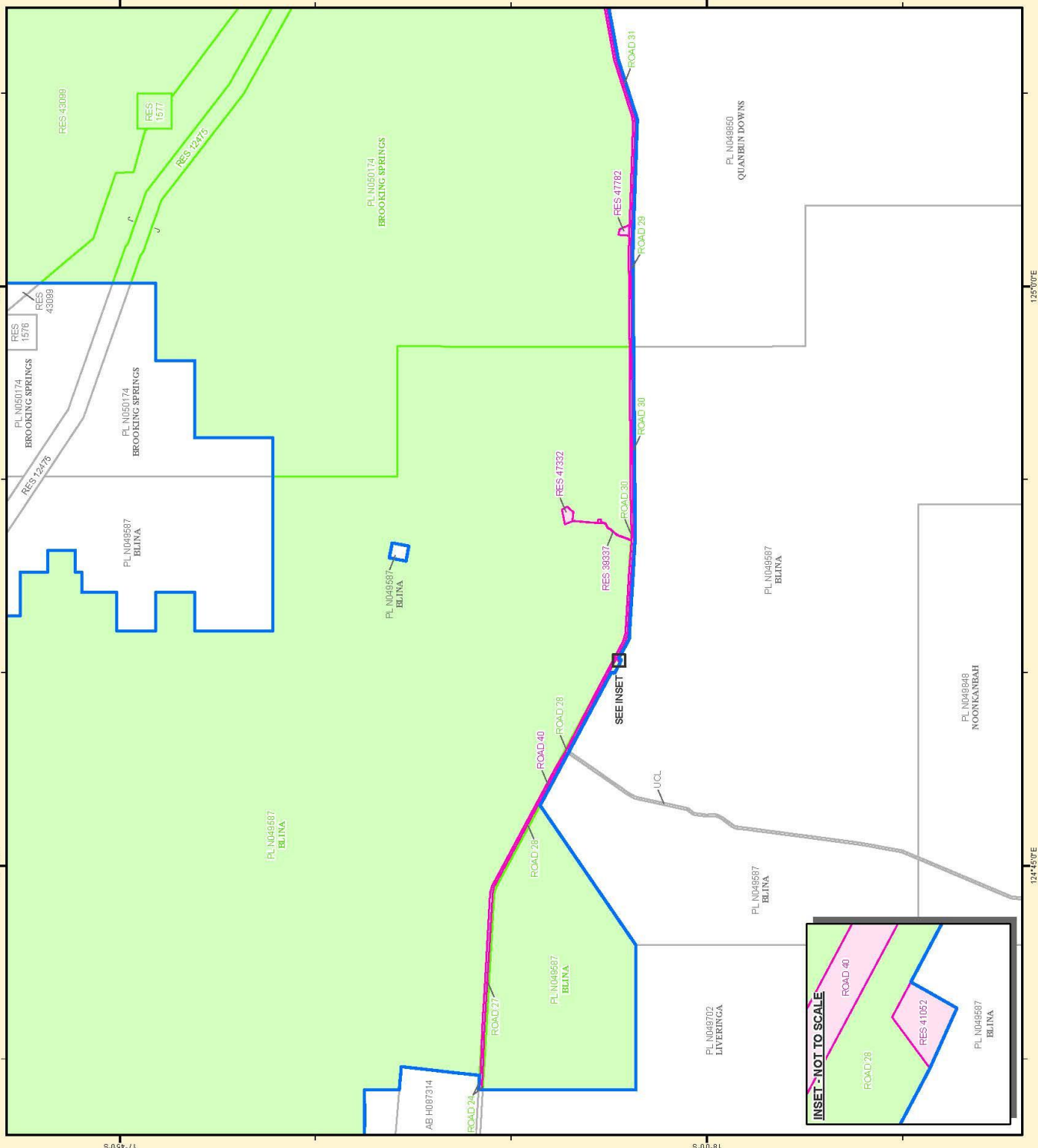

INSET - NOT TO SCALE

BUNUBA #2 PART A

DETERMINATION OF NATIVE TITLE WAD 94 of 2012

SCHEDULE 2 - ATTACHMENT 1

Enlargement 3

LEGEND

- DETERMINATION AREA
- AREAS OF LAND SUBJECT TO EXCLUSIVE NATIVE TITLE
- AREAS OF LAND SUBJECT TO NON-EXCLUSIVE NATIVE TITLE
- AREAS WHERE NATIVE TITLE DOES NOT EXIST
- OTHER INTERESTS



DATA SOURCES
 Cadastral and Information sources from Landgate, Spatial Information Systems, 29 June 2012.
 Geology data sourced from Landgate, Topographic Database, 2 February 2015.
 Administrative boundaries sourced from Landgate, Road Centreline Dataset, 2 February 2015.
 Contour lines sourced from Landgate, Road Centreline Dataset.
 Local Authorities boundaries sourced from Landgate, Local Government Areas, 29 June 2012.
 National Land Information System (NLIS) data sourced from Landgate, 29 June 2012.
 National Land Information System (NLIS) data sourced from Landgate, 29 June 2012.
 All referenced Diagrams, Plans and Diagrams are held by the Western Australian Land Information System (LIS).
 This is a not-for-sale only.

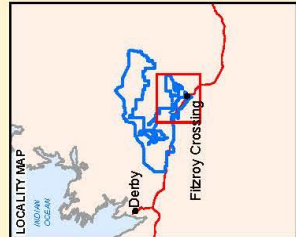

DISCLAIMER
 This map is a representation of the information available to Landgate at the time of production. It is not intended to be used for any purpose other than the purpose for which it was produced. Landgate does not warrant the accuracy or completeness of the information contained in this map. The user of this map should verify the information contained in this map with the relevant authorities. Landgate is not responsible for any loss or damage arising from the use of this map.

NATIVE TITLE SPATIAL SERVICES
 PRODUCED 12/02/2016
 Landgate
 Sheet address: 1 Midland Street, Midland, WA 8065
 Postal address: P.O. Box 2222, Midland, WA 8065
 Tel: (08) 9272 7391 Fax: (08) 9272 7615
 Internet: www.landgate.wa.gov.au

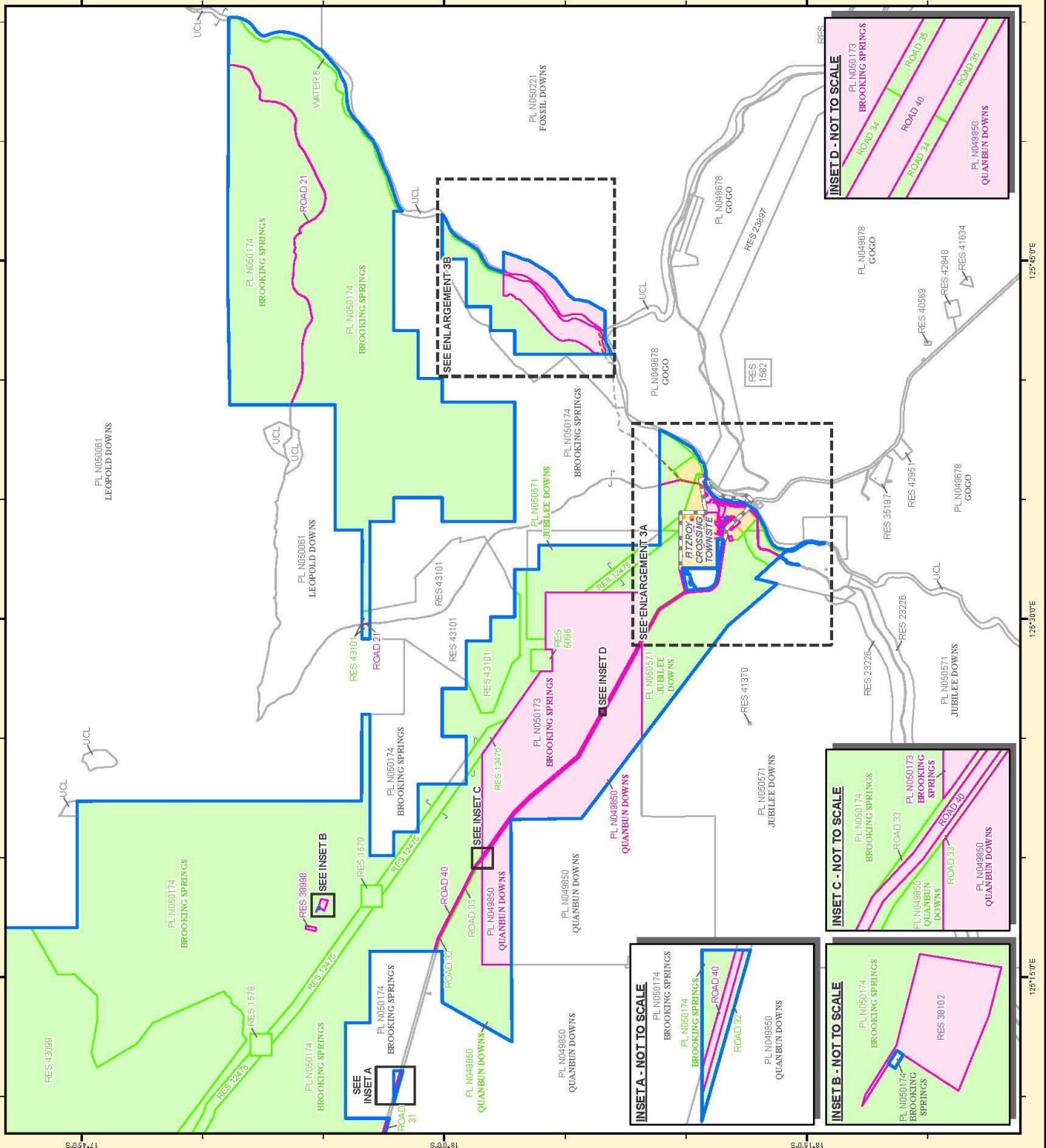

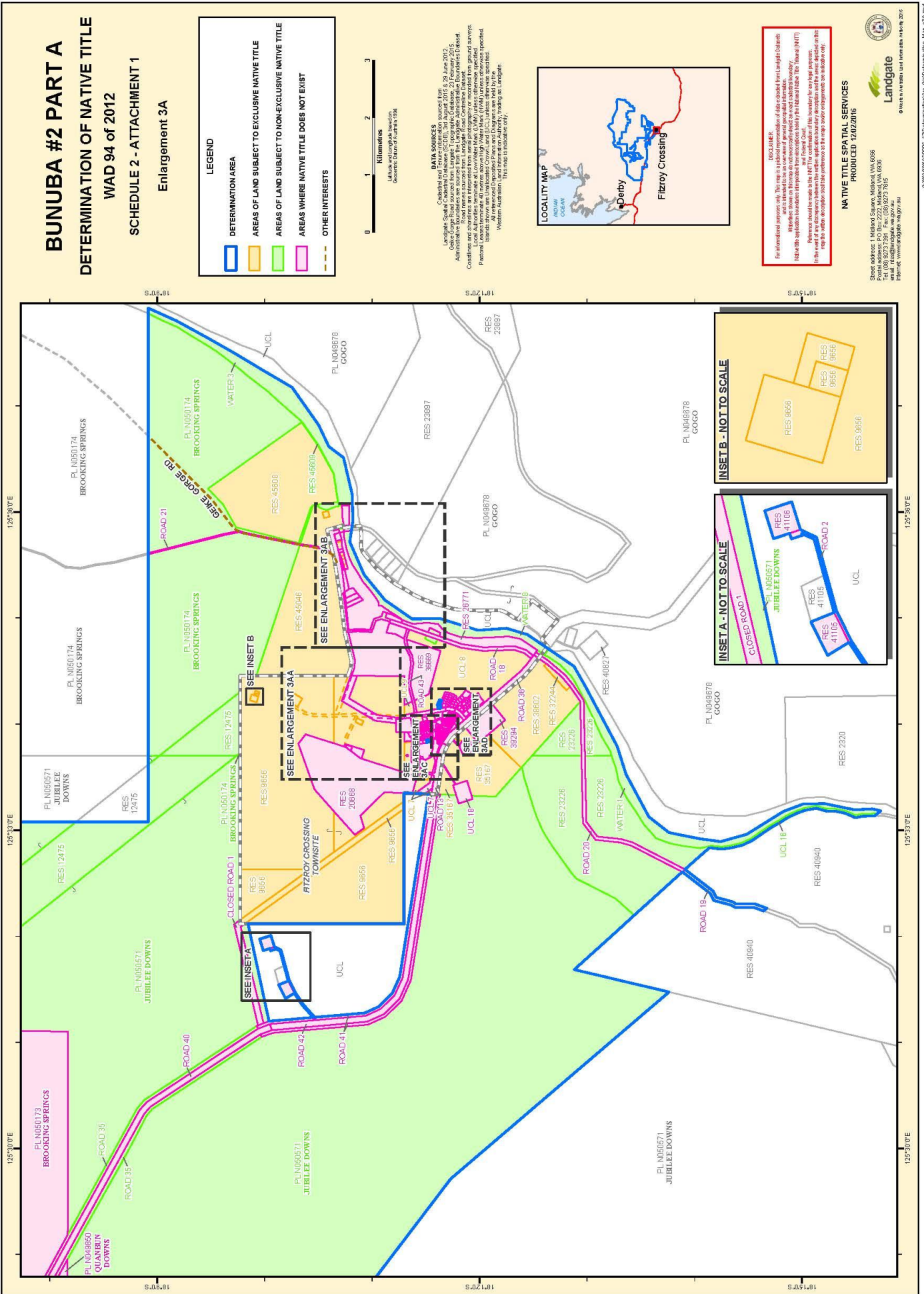

BUNUBA #2 PART A
DETERMINATION OF NATIVE TITLE
WAD 94 of 2012
SCHEDULE 2 - ATTACHMENT 1
Enlargement 3AA

LEGEND

- DETERMINATION AREA
- AREAS OF LAND SUBJECT TO EXCLUSIVE NATIVE TITLE
- AREAS OF LAND SUBJECT TO NON-EXCLUSIVE NATIVE TITLE
- AREAS WHERE NATIVE TITLE DOES NOT EXIST
- OTHER INTERESTS

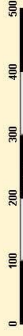

Labels based on Geographic Datum of Australia 1984

DATA SOURCES
 Cadastral and Tenure information sourced from Landgate's Survey and Cadastral Information Systems (SCIS) as at 23/06/2015. Other maps used include the Landgate Topographic Coverage 23 February 2015. Administrative boundaries are sourced from the Landgate Administrative Boundaries Dataset. Coordinates and street names are taken from aerial photography or recorded from ground surveys. Pastoral Leases terminate 4 indices above high water level. If PML areas are shown specified, boundaries are shown to the 4 indices above high water level. All referenced Deposition Plans and Diagrams are held by the Western Australian Land Information Authority, trading as Landgate.

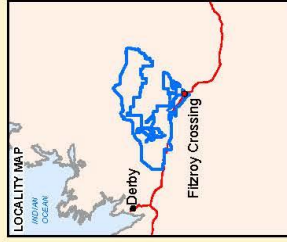

DISCLAIMER
 For information purposes only. This map is a partial representation of data collected from Landgate Datasets. It does not constitute a survey or any other form of measurement. It is not intended to be used as a substitute for a survey or any other form of measurement. It is not intended to be used as a substitute for a survey or any other form of measurement. It is not intended to be used as a substitute for a survey or any other form of measurement.

NATIVE TITLE SPATIAL SERVICES
 PRODUCED 12/12/2016

Sheet address: 1 Midland Square, Midland, WA 6006
 Tel: (08) 9272 2591 Fax: (08) 9272 7835
 Email: native.title@landgate.gov.au
 Internet: www.landgate.gov.au



© State of Western Australia 2016

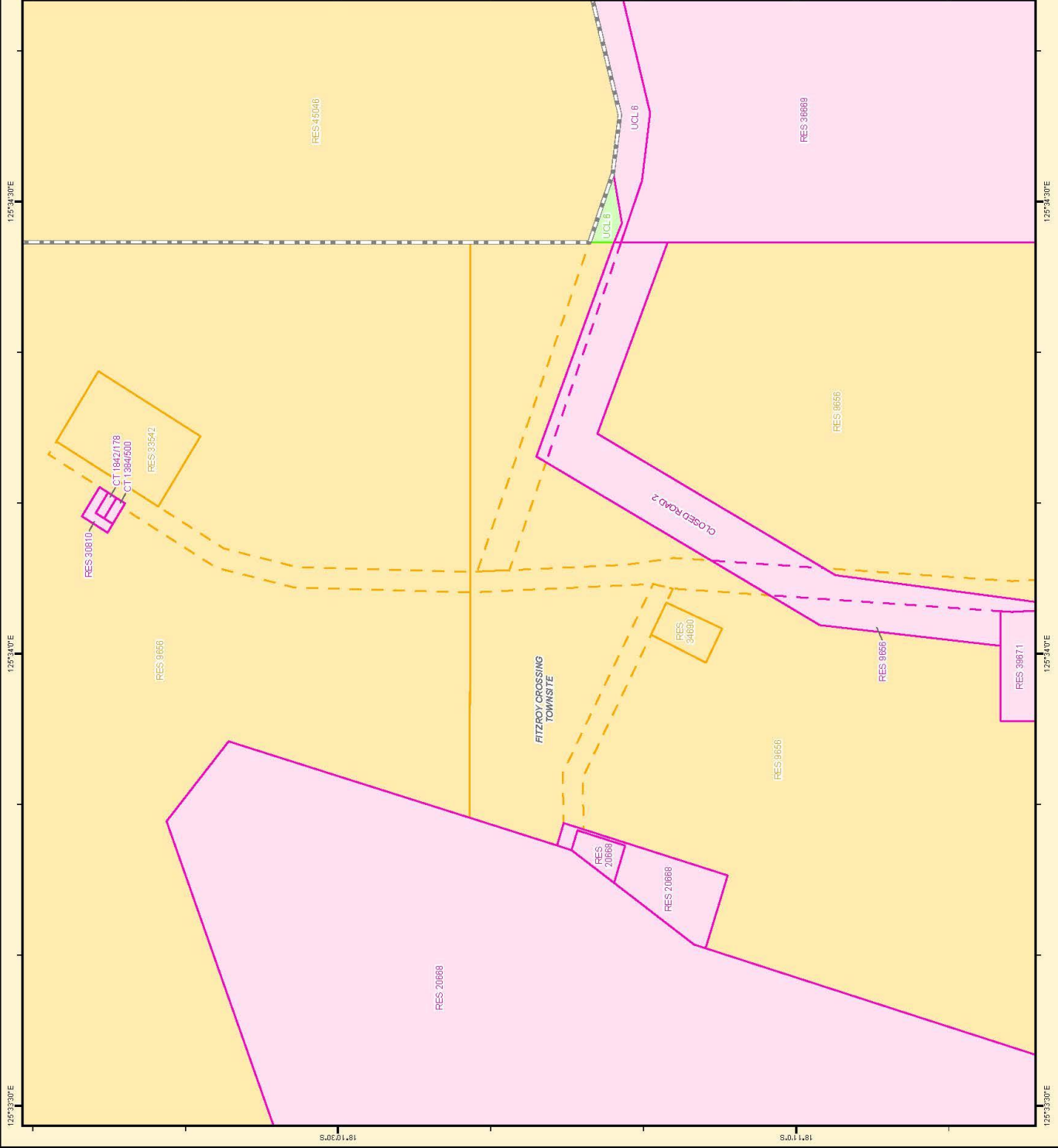

BUNUBA #2 PART A

DETERMINATION OF NATIVE TITLE WAD 94 of 2012 SCHEDULE 2 - ATTACHMENT 1 Enlargement 3AC

LEGEND

- DETERMINATION AREA
- AREAS OF LAND SUBJECT TO EXCLUSIVE NATIVE TITLE
- AREAS OF LAND SUBJECT TO NON-EXCLUSIVE NATIVE TITLE
- AREAS WHERE NATIVE TITLE DOES NOT EXIST
- OTHER INTERESTS



DATA SOURCES
 Collected and included from:
 Landgate Spatial Catalogue Database (SCD), 30th August 2015 & 29 June 2012
 Administrative boundaries are sourced from the Landgate Administrative Boundaries Dataset
 Coordinates and structures are interpreted from aerial photography or recorded from ground surveys
 Pastoral Licenses for leasehold interests are sourced from the Pastoral Licenses Dataset
 Interests above and below the ground are sourced from the Landgate Interests Dataset
 Western Australian Land Information Authority (Lantia) as of 12/02/2016

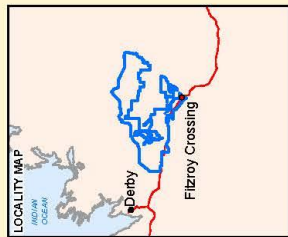

DISCLAIMER
 This map is a graphical representation of data collected from digital datasets for information purposes only. This map is not a legal document and should not be used as evidence in any legal proceedings.
 The boundaries shown on this map are not intended to be used as evidence of title or as a substitute for a survey.
 Reference should be made to the NAT for confirmation of the boundary for any legal purposes.
 The boundaries shown on this map are not intended to be used as evidence of title or as a substitute for a survey.

NATIVE TITLE SPATIAL SERVICES
 PRODUCED 12/02/2016

Landgate
 Street address: 1 Midland Square, Midland, WA 6005
 Tel: (08) 9272 2941 Fax: (08) 9272 7635
 Email: nativetitle@landgate.wa.gov.au
 Internet: www.landgate.wa.gov.au

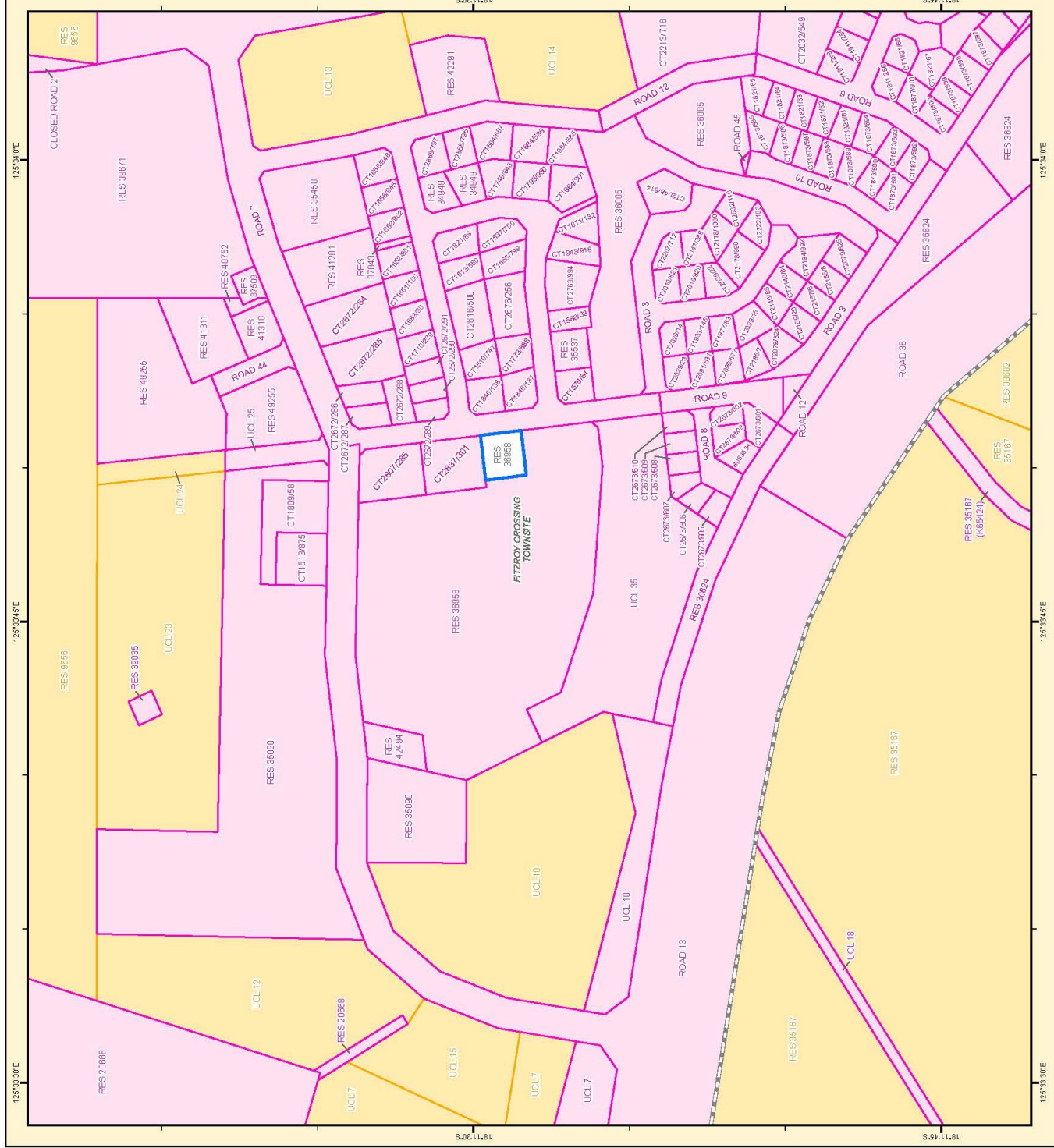

BUNUBA #2 PART A

DETERMINATION OF NATIVE TITLE

WAD 94 of 2012

SCHEDULE 2 - ATTACHMENT 1

Enlargement 3AD

LEGEND

- DETERMINATION AREA
- AREAS OF LAND SUBJECT TO EXCLUSIVE NATIVE TITLE
- AREAS OF LAND SUBJECT TO NON-EXCLUSIVE NATIVE TITLE
- AREAS WHERE NATIVE TITLE DOES NOT EXIST
- OTHER INTERESTS

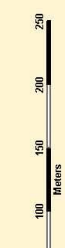

Latitude: 34°11'11.81"S
 Longitude: 151°34'15.00"E

DATA SOURCES
 Cadastre and Lease Information sources from the Department of Planning, Energy and Infrastructure, Queensland Government.
 Queensland Boundaries Database (QBD) - Queensland Government.
 Queensland Boundaries Database (QBD) - Queensland Government.
 Queensland Boundaries Database (QBD) - Queensland Government.
 Queensland Boundaries Database (QBD) - Queensland Government.

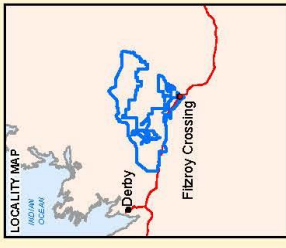

DISCLAIMER
 This map is for information purposes only. It is not intended to be used as a basis for legal proceedings and is intended to be used as a general guide only.
 The map is based on the best available information and is not intended to be used as a basis for legal proceedings.
 The map is not intended to be used as a basis for legal proceedings.

NATIVE TITLE SPATIAL SERVICES
 PRODUCED 12/02/2016

Share address: 1 Midland Square, Midland, WA 6550
 Postal address: PO Box 2222, Midland, WA 6550
 Email: native.title@landgate.wa.gov.au
 Internet: www.landgate.wa.gov.au

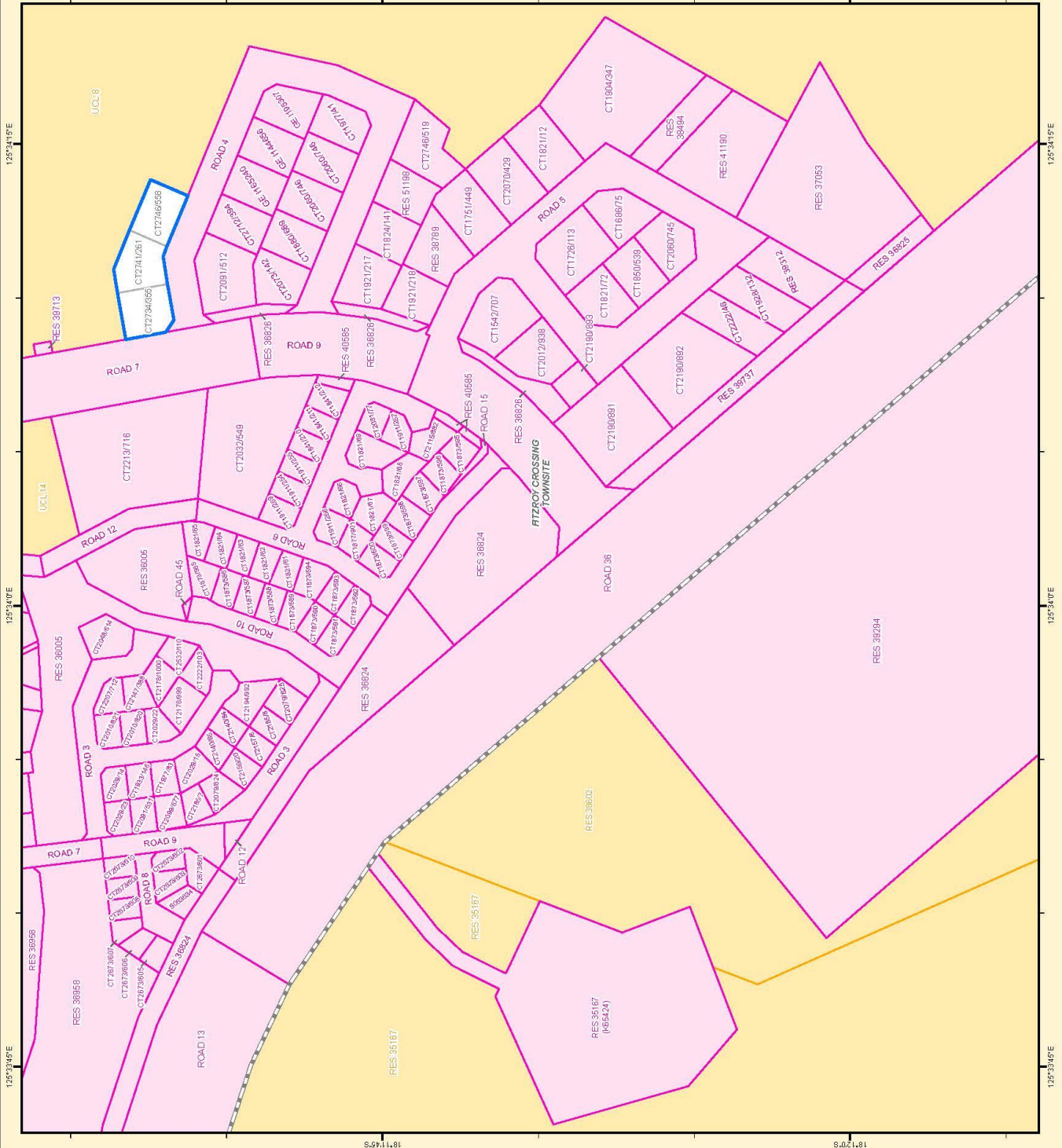

125°34'00"E 125°34'15"E 125°34'30"E 125°34'45"E

S.57.11.81 S.02.1.81

125°34'00"E 125°34'15"E 125°34'30"E 125°34'45"E

S.57.11.81 S.02.1.81

BUNUBA #2 PART A
DETERMINATION OF NATIVE TITLE
WAD 94 of 2012
SCHEDULE 2 - ATTACHMENT 1
Enlargement 3B

LEGEND

- DETERMINATION AREA
- AREAS OF LAND SUBJECT TO EXCLUSIVE NATIVE TITLE
- AREAS OF LAND SUBJECT TO NON-EXCLUSIVE NATIVE TITLE
- AREAS WHERE NATIVE TITLE DOES NOT EXIST
- OTHER INTERESTS



DATA SOURCES
 Cadastral Information System
 Landgate Spatial Catalogue Database (SCDB) 30th August 2015 & 29 June 2012.
 Office of Road Services (ORS) Road Network Data (2015)
 Road names sourced from Landgate Road Centreline Database
 Conditions and Land Use Data (LUD) (2015)
 Local Address Database of Low/Voltage Meters (LVM) (latest address specified)
 Product of the Western Australian Land Information Authority (LAI) (latest specified)
 Western Australian Land Information Authority (LAI) as of 1st July 2015.
 This map is indicative only.

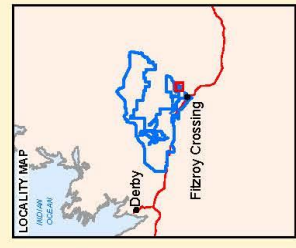

DISCLAIMER
 For information purposes only. This map is a general representation of data obtained from Landgate Database. It is not intended to be used as a legal document. The map is not necessarily an exact spatial boundary. Native title application boundaries interpretation is provided by the Native Title Tribunal (NTT). Reference should be made to the NTT for confirmation of the boundary for any legal purposes. While the map is a general representation of data, it may be subject to change without notice.

NATIVE TITLE SPATIAL SERVICES
 PRODUCED 12/02/2016

Landgate
 60 MARCH RD, EAST PERTH, WA 6150
 Tel: (08) 9223 2301 Fax: (08) 9223 7835
 Email: native.title@landgate.wa.gov.au

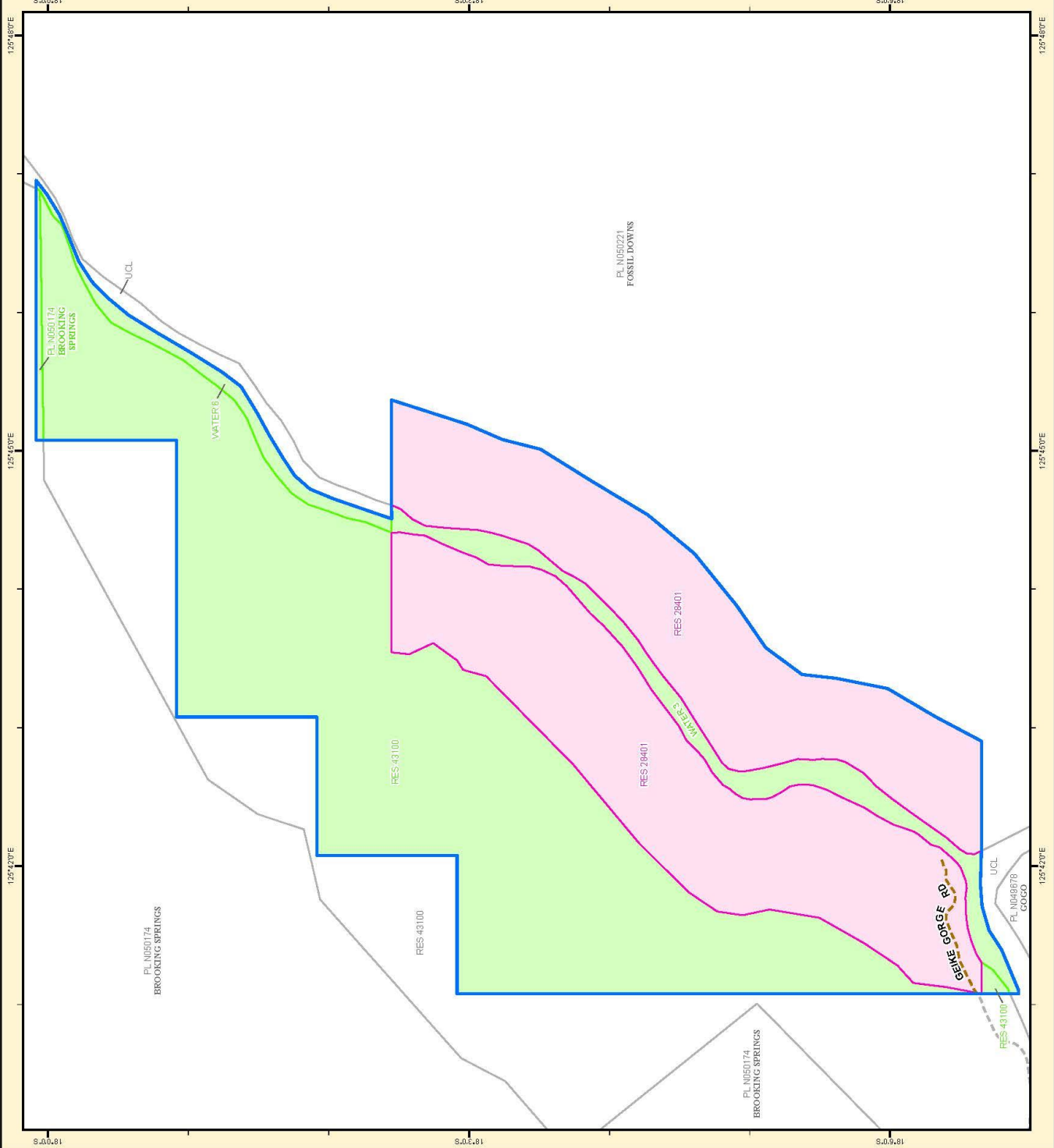

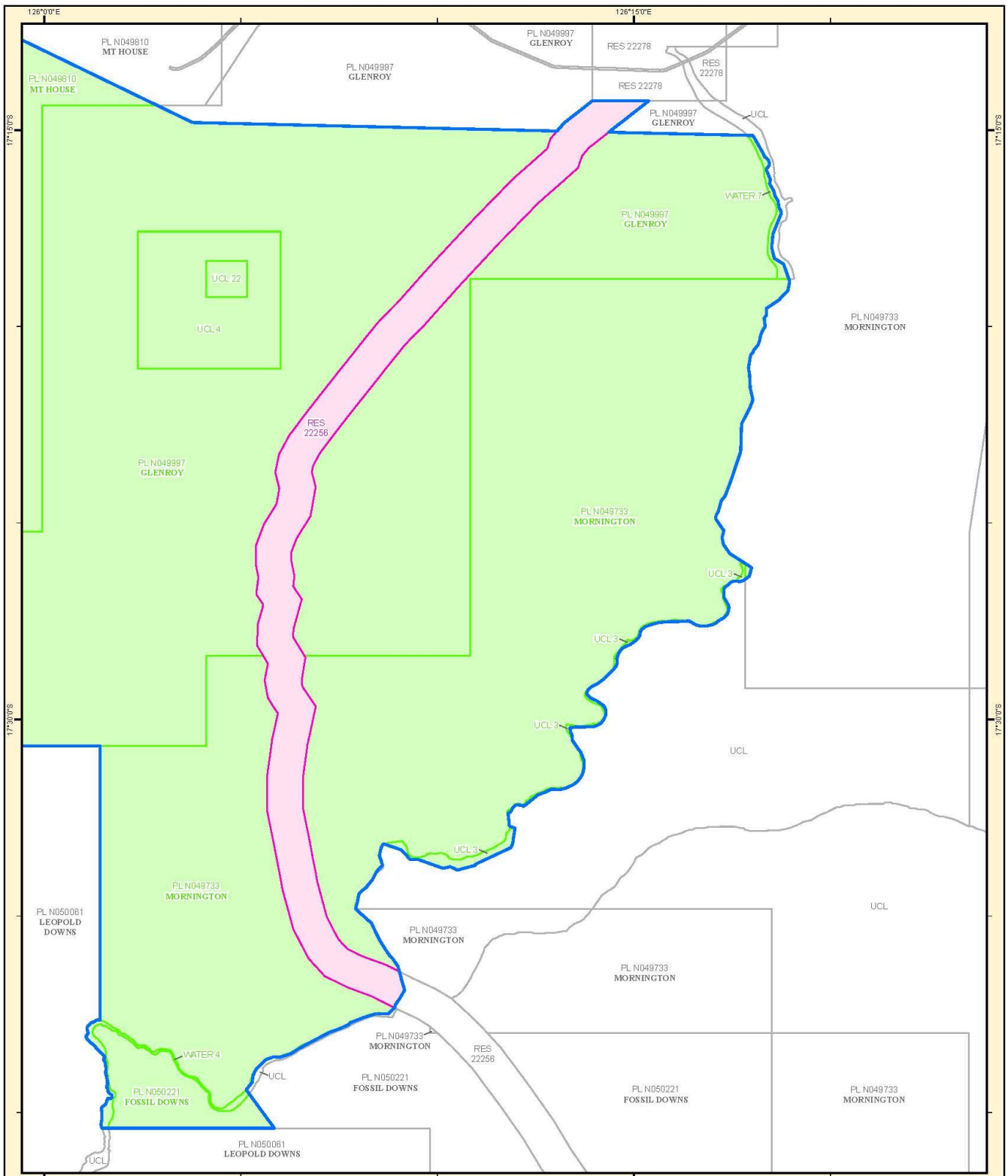

BUNUBA #2 PART A

DETERMINATION OF NATIVE TITLE

WAD 94 of 2012

SCHEDULE 2 - ATTACHMENT 1

Enlargement 4



Latitude and Longitude based on Geocentric Datum of Australia 1994

LEGEND	
	DETERMINATION AREA
	AREAS OF LAND SUBJECT TO EXCLUSIVE NATIVE TITLE
	AREAS OF LAND SUBJECT TO NON-EXCLUSIVE NATIVE TITLE
	AREAS WHERE NATIVE TITLE DOES NOT EXIST
	OTHER INTERESTS

DATA SOURCES
 Cadastral and Tenure information sourced from Landgate Spatial Catalogue (SCDB), 2nd August 2016 & 20 June 2012.
 Geospatial data sourced from Landgate Topographic Database, 23 February 2015.
 Administrative boundaries are sourced from the Landgate Administrative Boundaries Dataset.
 Road names sourced from Landgate Road Centreline Dataset.
 Contours and shorelines are interpreted from aerial photography or recorded from ground surveys.
 Local Authorities terminate at Low Water Mark (LWM) unless otherwise specified.
 Pastoral Lease or formline 40 metres above High Water Mark (HWM) unless otherwise specified.
 Islands shown are Unallocated Crown Land (UCL) unless otherwise specified.
 All referenced Diagrams, Plans and Diagrams are held by the Western Australian Land Information Authority, trading as Landgate.
 This map is indicative only.

DISCLAIMER
 For informational purposes only. This map is a potential representation of data collected from Landgate Datasets and is intended to be an overview of general geographical information.
 Boundaries shown on this map do not necessarily denote an exact cadastral boundary.
 Native title application boundaries interpreted from the application held by the National Native Title Tribunal (NNTT) and Federal Court.
 References should be made to the NNTT for confirmation of this boundary for any legal purposes.
 In the event of any discrepancy between the written application boundary description and the map depicted on this map the written description shall take precedence so the maps and/or enlargements are indicative only.



NATIVE TITLE SPATIAL SERVICES
 PRODUCED: 12/02/2016

Street address: 1 Midland Square, Midland, WA 6056
 Postal address: PO Box 222, Midland, WA 6056
 Tel: (81) 9273 7301 Fax: (81) 9273 7615
 email: nts@landgate.wa.gov.au
 Internet: www.landgate.wa.gov.au

Landgate
 Western Australia Land Information Authority 2016